

MODELS NOL6/NOL9

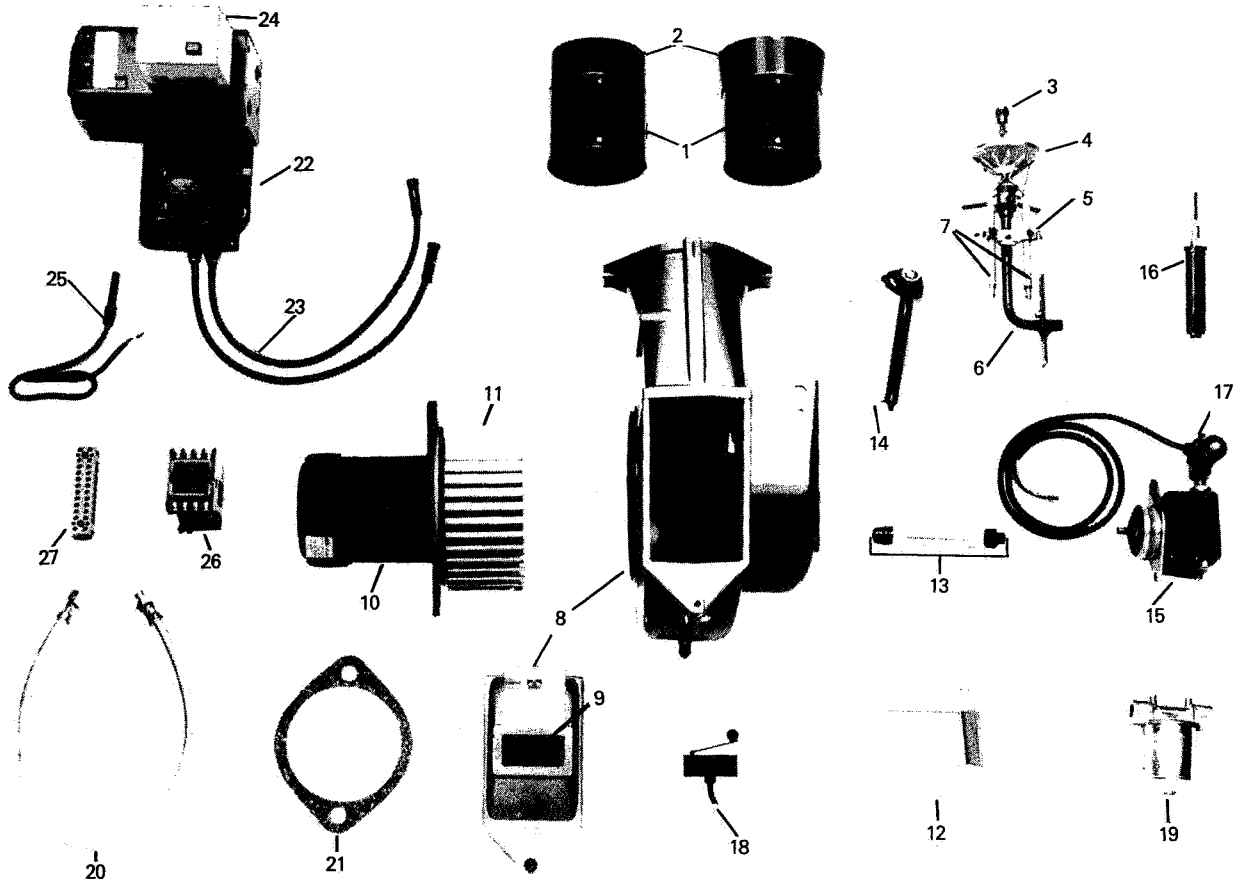

ITEM	CODE No.	DESCRIPTION
1A	U90-513L	NOL6 Draught Tube to Spec. advised
1B	U90-514M	NOL9 Draught Tube to Spec. advised
2A	M02-120S	Air Cone NOL6 only
2B	Z02-301H	Air Cone NOL9 only
3		Nozzle (Advise size & angle of spray)
4	N02-049E	Diffuser
5	Z26-502J	Electrode Bracket
6A	U90-054T	Inner Assembly to Spec. advised NOL6
6B	U90-055U	Inner Assembly to Spec. advised NOL9
7A	U90-364E	Electrode Block

ITEM	CODE No.	DESCRIPTION
7B	U90-301G	Electrodes Pair
8	U90-023L	Burner Casing Complete
9	G16-009C	Inspection Window
10A	A06-013M	Motor 1 Phase 250W AEG
10B	A06-014N	Motor 3 Phase 250W AEG
11	D06-006U	Fan Impellor Punker 160 x 74
12	P02-024V	Air Scoop
13	U90-604G	Coupling Set Complete NOL6-9
14		Air Flap (To Spec. advised)
15A	E02-015L	RSA40 Fuel Pump Danfoss

ITEM	CODE No.	DESCRIPTION
15B	E02-105U	AS47C Fuel Pump
15C	E02-054T	AP57C Fuel Pump
15D	E02-113K	AS67C Fuel Pump
15E	B16-030X	Coil to suit AS/AP Pump
16	E19-001X	Hydraulic Plunger
17A	E01-028Y	Solenoid V-matic
17B	E01-113J	Solenoid T.T.H. Twin
17C	E01-103Z	Solenoid 133 3 Way
18	B01-058R	Micro Switch (FCD only)
19A	E03-029T	Filter PP414
19B	E03-034Q	Element for PP414
19C	E03-011R	Filter Crosland 18489
19D	E03-022L	Element for 18489
20	E05-027K	Flexible Oil Pipe 18 x .25 BSP
21A	G09-008V	Gasket
21B	G09-016C	4 Bolt Adaptor Gasket

ITEM	CODE No.	DESCRIPTION
22	C02-024U	Transformer 52L0003
23	U90-403X	H.T. Leads
24A	C21-133Q	TF801B Control Box
24B	C21-078C	BH011 Control Box
24C	C21-138V	LOA21 Control Box
24D	C21-134R	TF802B Control Box
24E	C21-146V	TF830 Control Box
24F	C21-114M	Base to suit — T.F. Controls
24G	C21-208L	BH061 Control Box (Replaces BH011)
25A	C31-012L	L.D. (BH011) Photocell
25B	C31-038W	L.D. (BH061) Photocell
25C	C31-014N	QRB/1 Photocell
25D	C31-043T	FZ 711 Photocell Head
25E	C31-039X	MZ 770 Photocell Head
25F	C31-040C	Lead to suit — FZ/MZ Photocell
26	C56-044D	Contactoer CI9

IMPORTANT: It is essential when ordering spare parts that model number, serial number and specification number are quoted.

NOTES:

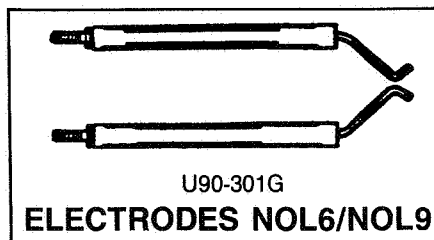
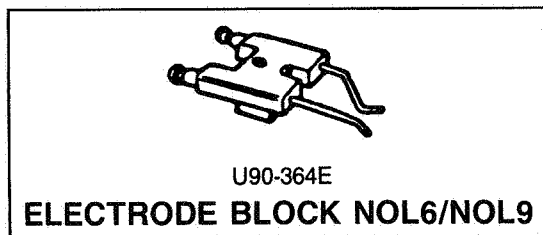

NU-WAY LIMITED, P.O. Box 1 Vines Lane, Droitwich,
Worcs. WR9 8NA, England.
Tel: Droitwich (01905) 794331 & 794242 (Direct Dial)
Facsimile: (01905) 794017
Parts & Components (01905) 795829
Email: info@nu-way.co.uk



An Enertech Group Company